

**All Metal**

[allmetalroofing.com.au](http://allmetalroofing.com.au)

## All Metal Snaplock - Data Sheet



ALL METAL ARCHITECTURAL PANELS

# All Metal Snaplock - Data Sheet

For increased panel lengths or a low pitched roof, the high ribbed All Metal Snaplock is an ideal choice. Mechanical seaming tools are not required for fixing Snaplock adding to the cost saving benefits of using this popular solution on walls or roof.

Rib Height	25mm		38mm		45mm		
Standard Panel Width	320mm	520mm	290mm	490mm	250mm	305mm	450mm
Custom Panel Width	180mm - 520mm		180mm - 490mm		200mm - 450mm		
Roof Pitch	Recommended minimum 3°				Recommended minimum 1.0°		
Base Metal Thickness	0.55mm, 0.70mm, 0.80mm BMT						
Panel Length	Up to 8m (longer lengths available on request)						
Fixing Screws, typical	Timber 10 - 12 X 25 Wafer Head type 17, Steel 10 - 16 X 16 Wafer Head Tek						
Fixing Clips	Fixing clips are available with or without countersunk fixing holes, choose clip to suit rib height						
Finishes	Colorbond®, Colorbond® Matt, Colorbond® Metallic, Colorbond® Ultra, UniCote® Lux, Magnaflow®, Zinalume®, Aluminium, Galvanised. Custom Colours are available (MOQ and extended lead times apply)						

## Installation

Panels can be installed vertically, horizontally, or diagonally. All Metal Snaplock is installed over a construction grade substrate. When used as roofing material, 19mm ply is recommended. A breathable waterproof membrane (e.g. Enviroseal™ HTS) is then placed in-between the All Metal Snaplock and the substrate. (for fixing aluminium, separation tape can be used to prevent contact between dissimilar metals) After ensuring that the substrate is completely level, a fixing clip is positioned over the male rib and screwed to the substrate or batten. A minimum of two screws per fixing clip should be used to fix clips into position. Fixing clips should be positioned not more than 600mm apart.

Once the first panel has been fixed into position, the following panel is then placed over the fixed panel with the female rib covering the male rib and fixing clip. Ensure that Snaplock panels are securely engaged by applying pressure to the female rib on the top panel.

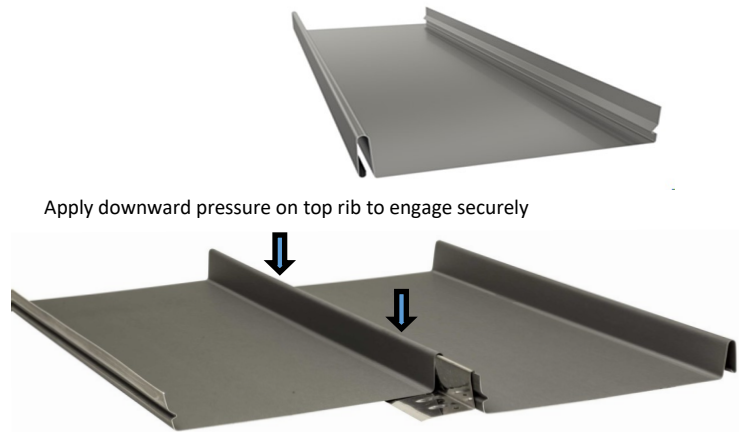
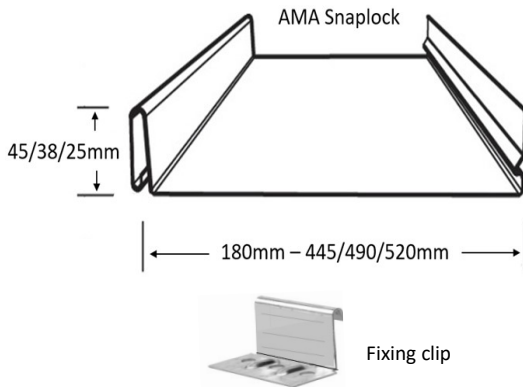

## Finishes

Select the perfect finish for your project from our wide range of options, samples and colour charts are available on request.

## Accessories

All Metal can provide custom made start and end panels as required. Our factory folded internal and external corner profiles or angle cut panels to suit your project dimensions will help simplify your installation. All Metal has everything you need to complete your project including specialised tools, fixing clips and made to order custom flashings.

**Tolerance:** All Metal will endeavour to produce finished products exactly as per the requested dimensions, please note that small variations can occur when folding or roll-forming products and as a result  $\pm 4\text{mm}$  will be deemed to be within acceptable tolerance.

**Fire Safety:** All Metal Interlock is made using material that has been independently tested in accordance with AS 1530.3. The test measures, Ignitability Index, Spread of Flame Index, Heat Evolved Index and Smoke Developed Index and are deemed non-combustible as per the National Construction Code of Australia in accordance with clauses C1.19.(e).(v) and 3.7.1.1 (e)

**Oil Canning:** When using any light gauge flat metal products, a ripple effect may become visible in areas of an installation. The condition is normally related to thermal movement. It can be minimized by taking due care during the installation process and avoiding excessively large flat pans or high gloss finishes, Oil canning is not a defect of the finished product and does not adversely affect the warranty or durability of the material and as such does not warrant rejection of the finished product. For more information please refer to our Oil Canning information sheet.



**Wetherill Park** Unit 1, 171-175 Newton Road, Wetherill Park NSW 2164  
Ph. 02 9756 3737 salessyd@allmetalaust.com.au

**Northern Beaches** 27 Ethel Avenue, Brookvale NSW 2100  
Ph. 02 9756 3737 salesbro@allmetalaust.com.au

**Mt Kuring-Gai** Unit 2/6-10 Yatala Road, Mt Kuring-Gai NSW 2080  
Ph. 0429 610 260 saleskur@allmetalaust.com.au

**Tuggerah** 8 Ace Cres, Tuggerah NSW 2259  
Ph. 02 4352 3111 salestug@allmetalaust.com.au

**Padstow** 2 Watson Road Padstow NSW 2211  
Ph. 02 9772 4400 salespad@allmetalaust.com.au

**Newcastle** 34 Huntington Drive, Thornton NSW 2322  
Ph. 02 4062 0339 salesnew@allmetalaust.com.au